



10' x 10' Rebounder Assembly

Item # 68304B

PARTS LIST

| Reference | Qty | Description | Qty | Description |
|-----------|-----|------------------------|------|-------------------|
| A | (2) | 61-1/4" Tube | (1) | Vinyl Skirt |
| B | (6) | 61-1/4" Tube with swag | (6) | Release Ty-raps |
| C | (2) | 20-1/2" Tube | (1) | Webbing Strap |
| 1 | (2) | 10-8 Kee Klamp | (20) | Bungee Cords |
| 2 | (2) | 15-8 Kee Klamp | (10) | Adjustable Straps |
| | (2) | 2" i.d. PVC sleeves | (1) | Set Screw Key |
| | (1) | Rebound Net | | |

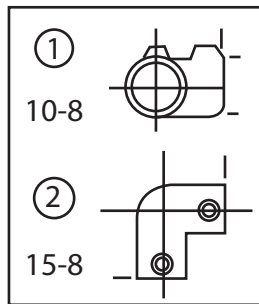
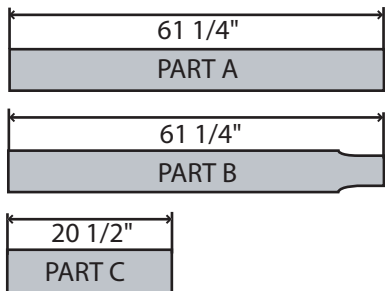

1. Sink PVC sleeves to a depth of 2' in concrete at least 3' deep, as shown on the illustration.
2. Assemble bottom bar over the holes as a guide. Lift off, lay down and finish assembly of frame on the ground. Use a set screw key to secure poles in fittings. Be sure the whole frame is assembled before installing the netting.
3. To install netting, fasten frame along sides and top using bungee cords. Hook every 8 mesh. Put tension on netting using (10) adjustable straps spaced evenly along the bottom.
4. Attach vinyl skirt at bottom using ty-raps. Thread webbing into netting at 3' height to simulate tennis net height.

